



Snow Gate™

Estate
agency
done
properly



66 Ryefields

Scholes, Holmfirth, HD9 1XF

A stunning and immaculate extended four bedroom family home in this very sought after village location with far reaching countryside views and gardens to three sides. The heart of the home is the fabulous open plan living and dining kitchen with contemporary high end kitchen and solid fuel stove. The accommodation briefly comprises entrance hallway, utility, home office, integral double garage, huge entertaining kitchen space, formal lounge and ground floor WC. To the first floor are four good sized bedrooms, master with ensuite and family bathroom. Plenty of off road parking and gardens to three sides. A short walk from the local shop and popular village Inn.

O.I.R.O £575,000

66 Ryefields

Scholes, Holmfirth, HD9 1XF



- LARGE AND EXTENDED FOUR DOUBLE BEDROOM FAMILY HOME
- PRIVATE LOCATION A SHORT WALK FROM THE VILLAGE AMENITIES
- HUGE OPEN PLAN LIVING/DINING KITCHEN WITH SOLID FUEL STOVE
- GARDENS TO THREE SIDES AND FAR REACHING VIEWS
- SEPARATE FORMAL LOUNGE AND VERSATILE STUDY
- DOUBLE GARAGE AND PLENTY OF OFF ROAD PARKING

Entrance

Utility Area

9'9" x 4'9" (2.97m x 1.45m)

Home Office

9'9" x 4'9" (2.97m x 1.45m)

Integral Garage

18'0" x 16'3" (5.49m x 4.95m)

Living/Dining Kitchen

23'6" x 23'2" max (7.16m x 7.06m max)

Inner Hallway

Ground Floor WC

5'10" x 5'7" (1.78m x 1.70m)

Lounge

20'1" x 13'3" (6.12m x 4.04m)

First Floor Landing

Master Bedroom

13'3" x 12'11" (4.04m x 3.94m)

Ensuite

10'1" x 5'7" (3.07m x 1.70m)

Bedroom 2

11'5" x 9'1" (3.48m x 2.77m)

Bedroom 3

11'0" x 7'4" (3.35m x 2.24m)

Bedroom 4

9'7" x 7'9" (2.92m x 2.36m)

Bathroom

7'9" x 6'3" (2.36m x 1.91m)

Parking

Gardens



Directions

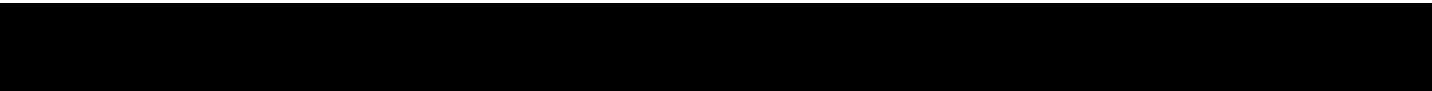



Floor Plan

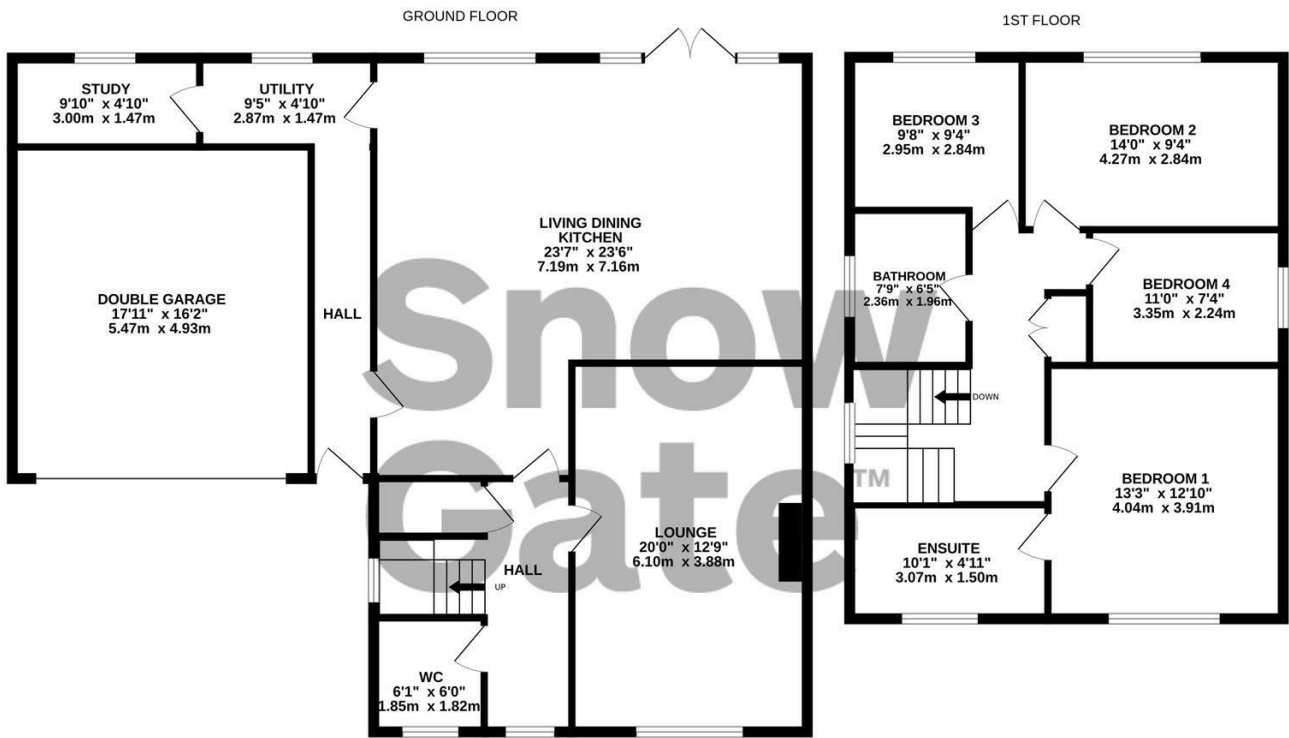

Whilst every attempt has been made to ensure the accuracy of the floorplan contained here, measurements of doors, windows, rooms and any other items are approximate and no responsibility is taken for any error, omission or mis-statement. This plan is for illustrative purposes only and should be used as such by any prospective purchaser. The services, systems and appliances shown have not been tested and no guarantee as to their operability or efficiency can be given.
Made with Metropix ©2026

These particulars, whilst believed to be accurate are set out as a general outline only for guidance and do not constitute any part of an offer or contract. Intending purchasers should not rely on them as statements of representation of fact, but must satisfy themselves by inspection or otherwise as to their accuracy. No person in this firms employment has the authority to make or give any representation or warranty in respect of the property.

